

**11.33  
HV**

# Zestaw śrubowy do połączeń sprężanych HV



Klasy:

Pokrycie:

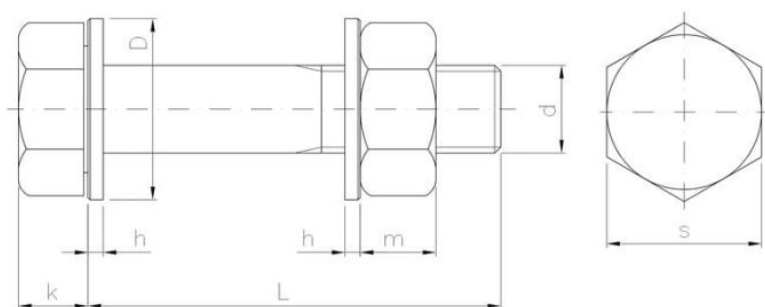

ZAPYTAJ O PRODUKT

+48 58 55 40 555

KUP W SKLEPIE MARCOPOL24

**Normy:**

PN-EN 14399



10.9

G

OCYNK  
OGNIOWY**Wymiary**

Material index	d - Średnica [mm]	L - Długość [mm]	k [mm]	s [mm]	m [mm]	h [mm]	D [mm]
1133240120G10HVP	M24	120	15	41	20.0	4.0	44
1133240110G10HVP	M24	110	15	41	20.0	4.0	44
1133240100G10HVP	M24	100	15	41	20.0	4.0	44
1133240095G10HVP	M24	95	15	41	20.0	4.0	44
1133240090G10HVP	M24	90	15	41	20.0	4.0	44
1133240085G10HVP	M24	85	15	41	20.0	4.0	44
1133240080G10HVP	M24	80	15	41	20.0	4.0	44
1133240075G10HVP	M24	75	15	41	20.0	4.0	44
1133240070G10HVP	M24	70	15	41	20.0	4.0	44
1133240060G10HVP	M24	60	15	41	20.0	4.0	44
1133200110G10HVP	M20	110	13	32	16.0	4.0	37
1133200100G10HVP	M20	100	13	32	16.0	4.0	37
1133200095G10HVP	M20	95	13	32	16.0	4.0	37
1133200090G10HVP	M20	90	13	32	16.0	4.0	37
1133200085G10HVP	M20	80	13	32	16.0	4.0	37
1133200080G10HVP	M20	80	13	32	16.0	4.0	37
1133200075G10HVP	M20	75	13	32	16.0	4.0	37
1133200070G10HVP	M20	70	13	32	16.0	4.0	37

Material index	d - Średnica [mm]	L - Długość [mm]	k [mm]	s [mm]	m [mm]	h [mm]	D [mm]
1133200065G10HVP	M20	65	13	32	16.0	4.0	37
1133200060G10HVP	M20	60	13	32	16.0	4.0	37
1133200055G10HVP	M20	55	13	32	16.0	4.0	37
1133200050G10HVP	M20	50	13	32	16.0	4.0	37
1133160100G10HVP	M16	100	10	27	13.0	4.0	30
1133160090G10HVP	M16	90	10	27	13.0	4.0	30
1133160080G10HVP	M16	80	10	27	13.0	4.0	30
1133160075G10HVP	M16	75	10	27	13.0	4.0	30
1133160070G10HVP	M16	70	10	27	13.0	4.0	30
1133160065G10HVP	M16	65	10	27	13.0	4.0	30
1133160060G10HVP	M16	60	10	27	13.0	4.0	30
1133160055G10HVP	M16	55	10	27	13.0	4.0	30
1133160050G10HVP	M16	50	10	27	13.0	4.0	30
1133160045G10HVP	M16	45	10	27	13.0	4.0	30
1133160040G10HVP	M16	40	10	27	13.0	4.0	30
1133120070G10HVP	M12	70	8	22	10.0	3.0	24
1133120060G10HVP	M12	60	8	22	10.0	3.0	24
1133120055G10HVP	M12	55	8	22	10.0	3.0	24
1133120050G10HVP	M12	50	8	22	10.0	3.0	24
1133120045G10HVP	M12	45	8	22	10.0	3.0	24
1133120040G10HVP	M12	40	8	22	10.0	3.0	24
1133120035G10HVP	M12	35	8	22	10.0	3.0	24
1133120030G10HVP	M12	30	8	22	10.0	3.0	24