



a brand that connects



PRODUCT CATALOGUE

# BLIND RIVETS

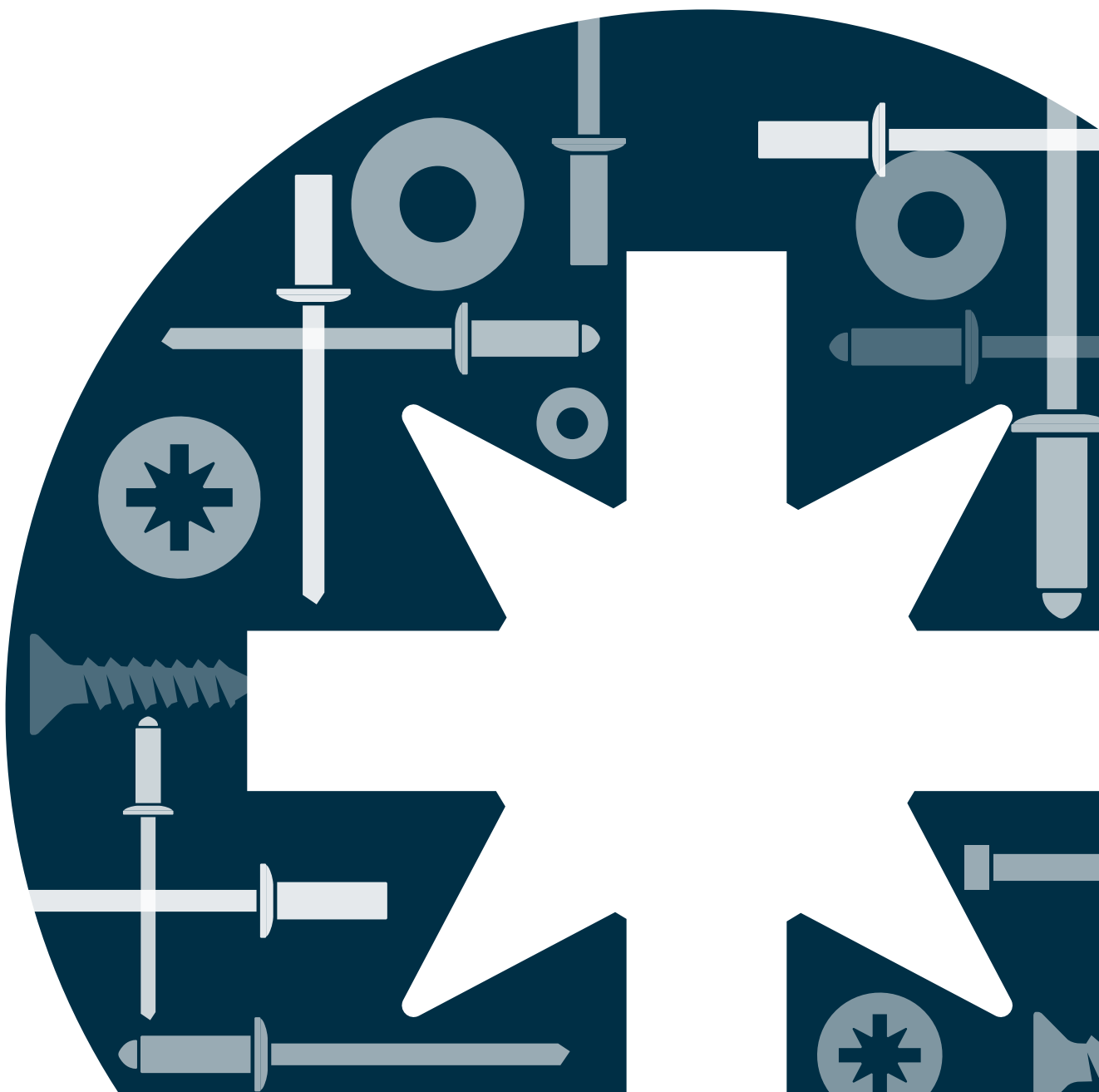



**37 years**  
of experience

---

More than PLN  
**20 k.**  
offered products

---

We have  
**12**  
trade offices

Daily we sell

**12.8 M +**

coupling elements

---

In the store there are

**30,000 +**

pallet places

---

**90%**

of orders placed by 14:00  
are sent within 24h!





# CONTENTS

1.0	General data	04
2.0	Blind rivets	11
3.0	Painted rivets	23
4.0	Sealed rivets	25
5.0	Multigrip rivets	28
6.0	Expanded rivets	29
7.0	Hardlock rivets	30
8.0	Assembly tools	31





# 1.0 GENERAL DATA

1.1	Structure of a rivet	05
1.2	Blind rivet installation	06
1.3	Principle of blind rivet installation	06
1.4	Selection of the rivet material depending on the ground	07
1.5	Galvanic corrosion	08
1.6	Basic types of the rivets	08
1.7	Division of rivets based on the material they are made from	09
1.8	Division of rivets based on the head shape	10





## 1.1 Structure of a rivet

A blind rivet consists of two parts:

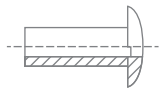

- rivet head - comes in different shapes, colours and can be made of different materials. The rivet head expands on the shank during riveting.



- rivet shank (core) - comes in standard or sealed version; it can be made of different materials

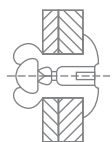

The rivet shank is always made of a harder material. The rivet shank always breaks off at a specific point. It ensures that it falls off when the rivet head properly joins the parts to be joined.



## 1.2 Blind rivet installation

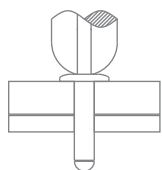

1. The rivet shank is placed in the riveting machine and the rivet head is installed in the hole between the parts to be joined.

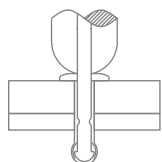

2. The rivet's shank is pulled by the jaws of the riveting machine. This causes deformation of the rivet head situated on the inner area of the elements to be joined.

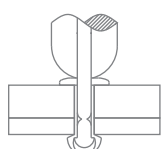

3. Further increase in the breaking force in the riveting machine and pulling of the rivet shank causes a crack formed in a well-defined place.

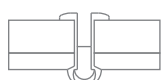

4. When the critical breaking force value has been exceeded, the rivet shank is broken off. At this point the rivet head permanently connects the two elements. The broken rivet shank is transported into a waste container.

To carry out the riveting process, certain tools called **riveting machines/riveters** are required.

## 1.3 Principle of blind rivet installation

### Dimensioning and preparation of the hole

In order to install rivets properly it is necessary to drill a hole with a diameter 0.1 mm larger than the diameter of the rivet head; if the holes are drilled, any burrs must be removed.

**Diameter of the rivet** – it must be at least equal to the thickness of the elements to be joined, but no more than three x the thickness of these elements.

**Distance of the hole from the edge** – holes must be drilled at a distance of at least two diameters from the edge of the element.

**Selection of materials of joined elements** – it is assumed that the material with better parameters (thickness, strength) should be on the side of the rivet head extension.



## 1.4 Selection of the rivet material depending on the ground

The selected rivet should generally have the same final and mechanical properties as the elements to be joined.

### ALUMINIUM

3.5% magnesium alloy (AlMg 3.5)

Universal application.

### ALUMINIUM

2.5% magnesium alloy (AlMg 2.5)

Softer aluminium suitable for materials prone to damage.

### ALUMINIUM

5.0% magnesium alloy (AlMg 5.0)

Harder aluminium suitable for applications requiring higher shear and tensile strength.

### STEEL

Universal application.

### STAINLESS STEEL

Suitable in corrosive environments and for applications in hospital environments or the food industry.

### COPPER-NICKEL ALLOY

Suitable in highly corrosive environments and when elevated temperatures occur.

### COPPER

It provides good electrical and thermal conductivity.







## 1.5 Galvanic corrosion

At the point where the rivet connects with the ground, a corrosion promoting galvanic cell can form. Hence, in the design of the connection, proper selection of the rivet material is extremely important. It must be based on the ground material.

The table provides general information about the possibility of corrosion between different materials.

RIVET MATERIAL	GROUND MATERIAL					
	AL	Fe	CS	A2	Cu	NC
Aluminium and alloys (AL)		■	■	■	■	■
Galvanized steel (Fe)	■		■	■	■	■
Carbon steel (CS)	■	■		■	■	■
Stainless steel (A2)	■	■	■		■	■
Copper (Cu)		■		■		■
Nickel and alloys (NC)		■	■	■	■	■

■ No corrosion    ■ Slight corrosion    ■ Quick corrosion    ■ Rapid corrosion

## 1.6 Basic types of rivets

**Standard rivetse** – the most basic types of rivets offering the widest range of applications. They can be made from a variety of materials;

**Open rivets** – suitable for low-load applications;

**Closed rivets** – allow retaining the shank. They are designed for more precise connections. They protect against moisture migration so they can be installed in areas exposed to elevated humidity;

**Sealed rivets** – used in spots where water tightness is required;



**Bifurcated rivets** – designed to operate in soft materials - wood, drywall, laminate or plastic;

**Expansion rivets** – are characterized by high clamping force, shank end retention and expansion on the inner side. It makes them resistant to tensile strength;

**Countersunk rivets** – open rivets that are countersunk into the hole on both sides during application. This ensures that the surface will be perfectly flat, without bulges;

**Grooved rivets** – thanks to grooving they can be used in blind holes.

## 1.7 Division of rivets based on the material they are made from

**Steel rivets** – the most universal rivets. They are suitable for the widest variety of applications;

**Copper rivets** – they are excellent conductors of heat and electricity;

**Aluminium rivets** – the most diverse group - their exact properties depend on how high the magnesium content is in the aluminium alloy. Rivets with the lowest magnesium content are quite soft, so they can be used to join delicate and vulnerable materials. When the magnesium content is slightly higher (about 3.5%), the fastener gains a universal character. Aluminium rivets with more than 5% magnesium content are hard. One can use them for work with demanding materials and in areas prone to tensile strength;

**Copper-nickel rivets** – suitable for areas extremely exposed to corrosion and high temperatures;

**Stainless steel rivets** – work well in corrosive environments and where sterility is required - including hospitals and the food industry.

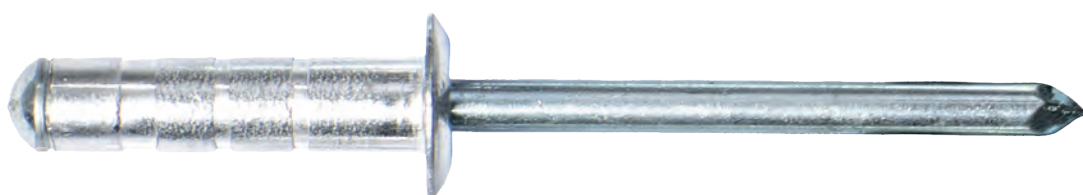



## 1.8 Division of rivets based on the head shap

Taking into account the shape of the head, we can distinguish the following types of rivets:



- **with a ball head** – characterized by a low profile; suitable for most applications;



- **with a large flange** – they are used to attach thin materials to hard substrates. The large flange is also great for masking a hole that is too large, ensuring tightness of the structure;



- **countersunk head** – using them you get a perfectly flat surface;

There are also rivets with cylindrical, semicircular, mushroom or lenticular heads.

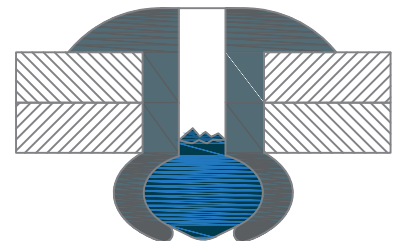
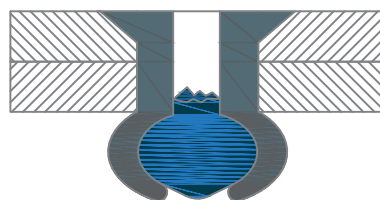
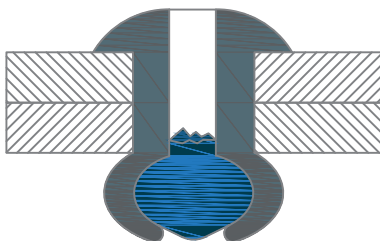



## 2.1 Flat head blind rivet STEEL/STEEL

PCS.

Group	<b>2401</b>
Material	<b>STEEL/STEEL</b>
Norm symbol	<b>St/St</b>
Standard	<b>PN-EN ISO 15979</b>

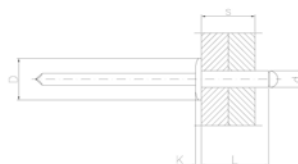

Flat head rivets are the basic type of rivets; widely applied. This type of rivet is most frequently used to join parts for which we want a flat, aesthetic surface after installation. Blind rivets can be made from combinations of different materials such as: steel-steel, aluminium-steel, stainless steel-stainless steel. We use steel-steel rivets mainly to make connections that work in dry conditions where there are no corrosive agents. Blind rivets can be painted according to the colours of the fastened elements which improves the aesthetics of the connection.

d	L	D	s	k				INDEX
3.0	6	6.3	1.00-3.00	1.3	3.10-3.20	1 000	4 000 (4)	641474
	8		3.00-5.00			1 000	4 000 (4)	641475
	10		5.00-6.50			1 000	4 000 (4)	641476
	12		6.50-8.00			1 000	4 000 (4)	641477
3.2	6	6.7	1.00-3.00	1.3	3.30-3.40	1 000	4 000 (4)	641478
	8		3.00-5.00			1 000	4 000 (4)	641479
	10		5.00-6.50			1 000	4 000 (4)	641480
	12		6.50-8.00			1 000	4 000 (4)	647998
4.0	6	8.4	1.00-3.00	1.7	4.10-4.20	1 000	4 000 (4)	648615
	8		3.00-5.00			1 000	6 000 (6)	648617
	10		5.00-6.50			1 000	4 000 (4)	648619
	12		6.50-9.00			500	2 000 (4)	641483
	14		8.50-10.00			500	2 000 (4)	641484
	16		9.00-12.00			500	2 000 (4)	641485
	18		12.00-14.00			500	2 000 (4)	641486
	20		12.00-16.00			500	2 000 (4)	641487





## 2.1 Flat head blind rivet STEEL/STEEL

**PCS.**

 d	 L	 D	 s	 k			 KG	INDEX
4.8	6	10.10	1.50-2.50	2.0	4.90-5.00	500	2 000 (4)	641488
	8		2.50-4.00			500	2 000 (4)	641489
	10		4.00-6.00			500	2 000 (4)	641490
	12		6.00-8.00			500	2 000 (4)	641491
	14		7.50-9.50			500	2 000 (4)	641492
	16		8.00-11.00			500	2 000 (4)	641493
	18		10.00-13.00			500	2 000 (4)	641494
	20		11.00-15.00			250	1 000 (4)	641495
	21		15.00-20.00			250	1 000 (4)	641496
	24		20.00-25.00			250	1 000 (4)	641497
	30		25.00-30.00			250	1 000 (4)	641498
	35		25.0-30.0			250	1 000 (4)	641499
5.0	8	10.5	2.50-4.00	2.1	5.10-5.20	500	2 000 (4)	648632
	10		4.00-6.00			500	2 000 (4)	648634
	12		6.00-8.00			500	2 000 (4)	648636
	14		7.50-9.50			250	2 000 (8)	641503
	16		8.00-11.00			250	2 000 (8)	641504
	18		10.00-13.00			250	1 000 (4)	641505
	20		11.00-15.00			250	1 000 (4)	641506
	25		15.00-19.50			250	1 000 (4)	641507
	30		19.5-25.00			250	1 000 (4)	641508
6.0	10	12.6	3.00-4.00	2.5	6.10-6.20	250	1 000 (4)	641509
	12		4.00-6.00			250	1 000 (4)	641510
	16		7.00-11.00			200	800 (4)	641511
	18		10.00-12.00			200	800 (4)	641512
	30		19.00-24.00			250	800 (4)	641513
6.4	12	13.4	4.00-6.00	2.7	6.50-6.60	150	1 200 (8)	648652
	15		6.00-10.00			150	1 200 (8)	648653
	18		7.00-11.00			150	600 (4)	648654
	20		9.00-13.00			100	800 (8)	641517
	25		13.00-19.00			100	800 (8)	641518
	30		19.00-24.00			100	400 (4)	641519



## 2.2 Flat head blind rivet ALU/STEEL

**PCS.**

Group	<b>2402</b>
Material	<b>ALUMINIUM/STEEL</b>
Norm symbol	<b>AIA/St</b>
Standard	<b>PN-EN ISO 15977</b>

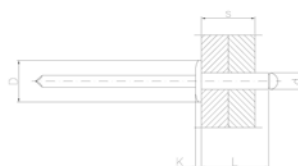









Aluminium-steel rivets are a group of the most versatile products in the rivet family. Their properties depend on the percentage of the magnesium in the aluminium alloy. Rivets with the lowest magnesium concentration are quite soft, so they can be used to join delicate and vulnerable materials. When the magnesium content is slightly higher (about 3.5%), the product gains versatility. Aluminium rivets with more than 5% magnesium content are hard. One can use them for work with demanding materials and in areas prone to tensile strength.

								INDEX
3	6	6.3	1.00-3.00	1.3	3.10-3.20	1 000	4 000 (4)	641319
	8		3.00-5.00			1 000	4 000 (4)	641320
	10		5.00-6.50			1 000	4 000 (4)	641321
	12		6.50-8.00			1 000	4 000 (4)	641322
	16		9.00-12.00			1 000	4 000 (4)	641323
3,2	6	6.7	1.00-3.00	1,3	3.30-3.40	1 000	4 000 (4)	641324
	8		3.00-5.00			1 000	4 000 (4)	641325
	10		5.00-6.50			1 000	4 000 (4)	641326
	12		6.50-8.00			1 000	4 000 (4)	641327
	16		8.00-12.00			1 000	4 000 (4)	641328
4	6	8.4	1.00-3.00	1.7	4.10-4.20	500	4 000 (8)	648616
	8		3.00-5.00			500	2 000 (4)	648618
	10		5.00-6.50			500	2 000 (4)	648620
	12		6.50-9.00			500	2 000 (4)	641337
	14		8.50-10.00			500	2 000 (4)	641338
	16		9.00-12.00			500	2 000 (4)	641339
	18		12.00-14.00			500	2 000 (4)	641340
	20		12.00-16.00			500	3 000 (6)	645072
	25		16.00-20.00			500	2 000 (4)	641342
	30		20.00-25.00			500	2 000 (4)	648621











## 2.2 Flat head blind rivet ALU/STEEL

**PCS.**

 d	 L	 D	 s	 k			 KG	INDEX
4.8	6	10.10	1.50-2.50	2.0	4.90-5.00	500	2 000 (4)	641344
	8		2.50-4.00			500	2 000 (4)	641345
	10		4.00-6.00			500	2 000 (4)	641346
	12		6.00-8.00			500	2 000 (4)	641347
	14		7.50-9.50			500	3 000 (6)	645073
	16		8.00-11.00			500	2 000 (4)	641349
	18		10.00-13.00			500	2 000 (4)	641350
	20		11.00-15.00			250	1 000 (4)	648630
	24		15.00-20.00			250	1 000 (4)	648631
	30		20.00-25.00			250	1 000 (4)	641352
	35		25.00-30.00			250	1 000 (4)	641353
5	8	10.5	2.50-4.00	2.1	5.10-5.20	250	2 000 (8)	648633
	10		4.00-6.00			250	1 000 (4)	648635
	12		6.00-8.00			250	1 000 (4)	648637
	14		7.50-9.50			250	1 000 (4)	648638
	16		8.00-11.00			250	1 000 (4)	648639
	18		10.00-13.00			250	1 000 (4)	648640
	20		11.00-15.00			250	1 000 (4)	648641
	25		15.00-19.50			250	1 000 (4)	641361
	30		19.5-25.00			250	1 000 (4)	641362
6	10	12.6	3.00-4.00	2.5	6.10-6.20	250	1 000 (4)	641363
	12		4.00-6.00			250	1 000 (4)	641364
	16		7.00-11.00			250	1 000 (4)	648645
	18		10.00-12.00			250	1 000 (4)	648647
	20		10.00-14.00			250	1 000 (4)	648648
	25		14.00-19.00			250	1 500 (6)	648649
	30		19.00-24.00			250	1 500 (6)	648651

## 2.2 Flat head blind rivet ALU/STEEL

**PCS.**  
**- cardboards 2.5 kg**

 d	 L	 D	 s	 k		PCS. in KG.			INDEX
3	6	6.3	1.00-3.00	1.3	3.10-3.20	1020	2,5	10 (4)	631843
	8		3.00-5.00			980	2,5	5 (2)	631844
	10		5.00-6.50			970	2,5	5 (2)	631845
	12		6.50-8.00			950	2,5	5 (2)	631846
	14		8.00-11.00			930	2,5	5 (2)	631847
4	6	8.4	1.00-3.00	1.7	4.10-4.20	740	2,5	10 (4)	631848
	8		3.00-5.00			710	2,5	10 (4)	631849
	10		5.00-6.50			630	2,5	10 (4)	631850
	12		6.50-9.00			600	2,5	10 (4)	631851
	14		8.50-10.00			580	2,5	5 (2)	631852
	16		9.00-12.00			540	2,5	5 (2)	631853
	20		12.00-16.00			440	2,5	5 (2)	631854
4.8	8	10.1	2.50-4.00	2.0	4.90-5.00	430	2,5	5 (2)	631855
	10		4.00-6.00			390	2,5	5 (2)	631856
	12		6.00-8.00			360	2,5	10 (4)	631857
	14		7.50-9.50			345	2,5	10 (4)	631858
	16		8.00-11.00			330	2,5	10 (4)	645007
	18		10.00-13.00			315	2,5	5 (2)	631860
	20		11.00-15.00			290	2,5	10 (4)	631861
	24		15.00-20.00			275	2,5	10 (4)	631862
	30		20.00-25.00			260	2,5	5 (2)	631863
5	8	10.5	2.50-4.00	2.1	5.10-5.20	400	2,5	10 (4)	643962
	10		4.00-6.00			385	2,5	5 (2)	631865
	12		6.00-8.00			360	2,5	10 (4)	631866
	14		7.50-9.50			350	2,5	5 (2)	631867
	16		8.00-11.00			330	2,5	10 (4)	631868
	18		10.00-13.00			320	2,5	5 (2)	631869
	20		11.00-15.00			250	2,5	10 (4)	631870
	6.0		12			12.6	4.00-6.00	2.5	6.10-6.20
16		7.00-11.00	200	2,5	10 (4)		642881		
18		10.00-12.00	192	2,5	10 (4)		631873		



## 2.2 Flat head blind rivet ALU/STEEL

PCS.  
- bags 2.5 kg

 d	 L	 D	 s	 k		 KG	INDEX
3.0	8	6.3	3.00-5.00	1.3	3.10-3.20	1 (10)	644502
	12		6.50-8.00			1 (10)	644504
4	6	8.4	1.00-3.00	1.7	4.10-4.20	1 (10)	644506
	8		3.00-5.00			1 (10)	644507
	10		5.00-6.50			1 (10)	644508
	12		6.50-9.00			1 (10)	644509
	16		9.00-12.00			1 (10)	644511
4.8	8	10.1	2.50-4.00	2.0	4.90-5.00	1 (10)	644513
	10		4.00-6.00			1 (10)	644514
	12		6.00-8.00			1 (10)	644515
	14		7.50-9.50			1 (10)	644516
	20		11.00-15.00			1 (10)	644519
	24		15.00-20.00			1 (10)	644520
5	8	10.5	2.50-4.00	2.1	5.10-5.20	1 (10)	644522
	12		6.00-8.00			1 (10)	644524
	16		8.00-11.00			1 (10)	644526
	20		11.00-15.00			1 (10)	644528
6	16	12.6	7.00-11.00	2.5	6.10-6.20	1 (10)	644530
	18		10.00-12.00			1 (10)	644531





## 2.3 Sealed flat head blind rivets A2/A2

**PCS.**

Group	<b>I2401</b>
Material	<b>STAINLESS STEEL x 2</b>
Standard	<b>DIN-EN ISO15984</b>

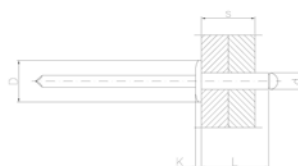

d	L	D	s	k				INDEX
3.0	6	6.3	1.00-3.00	1.3	3.10-3.20	500	4 000 (8)	635230
	8		3.00-5.00					635231
	10		5.00-6.50					635232
	12		6.50-8.50					635233
3.2	6	6.7	1.00-3.00	1.3	3.30-3.40	500	4 000 (8)	635234
	8		3.00-5.00					643063
	10		5.00-6.50					84114
	12		6.50-8.50					98675
4.0	6	8.4	1.00-2.50	1.7	4.10-4.20	500	4 000 (8)	84116
	8		3.00-5.00					643062
	10		4.50-6.50					635237
	12		6.50-8.50					635238
	16		10.00-12.00					635239
	20		14.00-16.00					648278
4.8	10	10.10	4.00-6.00	2.0	4.90-5.00	500	2 000 (4)	635240
	12		6.00-8.00					635241
	14		6.00-9.50					648607
	16		8.00-11.00					635242
	18		11.00-13.00					635243
	20		13.00-16.00					648608





## 2.4 Large flat head blind rivet ALU/STEEL

**PCS.**

Group	<b>2403</b>
Material	<b>ALUMINIUM/STEEL</b>

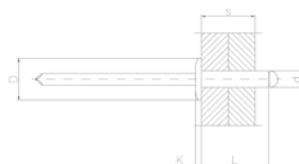

Extended flange rivets are used to fasten thin materials to hard substrates. The large flange also helps mask an oversized hole and prevent free migration of moisture.

### LARGE HEAD 12mm

								INDEX
4.0	8	12.5	3.00-5.00	2.2	4.10-4.20	500	2 000 (4)	641520
	10		5.00-6.50			500	2 000 (4)	641521
	12		6.50-8.50			500	2 000 (4)	641522
	14		8.50-10.50			500	2 000 (4)	641523
	16		8.50-12.50			500	2 000 (4)	641524
	18		12.50-14.50			500	2 000 (4)	641525
	20		12.50-16.50			500	2 000 (4)	641526

### LARGE HEAD 14mm

								INDEX
4.8	12	14.5	6.00-8.00	2.5	4.9-5.0	500	2 000 (4)	641528
	14		8.00-10.00			500	2 000 (4)	641530
	16		8.00-12.00			500	3 000 (6)	648625
	18		12.00-13.50			500	3 000 (6)	648628
	21		12.00-15.00			250	1 500 (6)	645074
	24		16.00-19.00			250	1 000 (4)	641538
	30		20.00-25.00			250	1 000 (4)	641540
5	12	14.5	6.00-8.00	2.5	5.10-5.20	250	1 000 (4)	643636
	16		8.00-12.00			250	1 000 (4)	641543
	18		12.00-13.50			250	1 000 (4)	641544
	20		12.00-15.00			250	1 000 (4)	641545
	25		15.00-20.00			250	1 000 (4)	648642
	30		20.00-25.00			250	1 000 (4)	648643













## 2.4 Large flat head blind rivet ALU/STEEL

PCS.

### LARGE HEAD 16mm

 d	 L	 D	 s	 k			 KG	INDEX
4.8	10	16.5	4.00-6.00	2.5	4.9-5.0	500	2 000 (4)	641527
	12		6.00-8.00			500	2 000 (4)	641529
	14		8.00-10.00			500	2 000 (4)	641531
	16		8.00-12.00			500	3 000 (6)	648626
	18		12.00-13.50			500	3 000 (6)	648629
	21		12.00-15.00			250	1 000 (4)	641537
	24		16.00-19.00			250	1 000 (4)	641539
	30		20.00-25.00			250	1 000 (4)	641541





## 2.5 Countersunk head 120° rivet STEEL/STEEL

**PCS.**

Group	<b>2404</b>
Material	<b>STEEL/STEEL</b>
Norm symbol	<b>St/St</b>
Standard	<b>PN-EN ISO 15980</b>

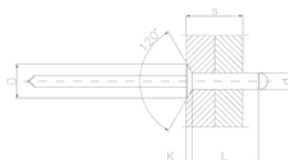

Countersunk rivets are countersunk into the hole on both sides during application. As a result, the surface is perfectly flat with no visible bulges.

PCS.								
								INDEX
4.8	8	10.1	2.50-4.00	2.0	4.90-5.00	500	4 000 (8)	641548
	10		4.00-6.00			500	2 000 (4)	641549





## 2.6 Countersunk head 120° blind rivet ALU/STEEL

**PCS.**

Group	<b>2405</b>
Material	<b>ALUMINIUM/STAL</b>
Norm symbol	<b>AIA/St</b>
Standard	<b>PN-EN ISO 15978</b>

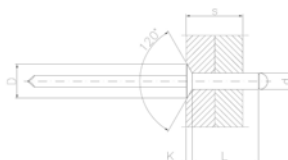

PCS.								
								INDEX
3.0	10	6.3	5.00-7.00	1.3	3.10-3.20	1000	4000 4	641552
	12		7.00-9.00			1000	4000 4	641553
3.2	6	6.7	2.00-3.50	1.3	3.30-3.40	1000	4000 4	641554
	10		5.00-7.00			1000	4000 4	641555
	12		7.00-9.00			1000	4000 4	641554
4.0	8	8.4	2.00-5.00	1.5	4.10-4.20	500	500 4	641557
	10		5.00-6.50			500	2000 4	641558
	12		6.50-8.50			500	2000 4	641559
	14		8.50-10.50			500	2000 4	641560
	16		8.50-12.50			500	2000 4	641561
4.8	12	10.1	6.00-8.00	1.5	4.90-5.00	500	2000 4	641562
	16		8.00-12.00			500	2000 4	641563
	18		10.00-13.00			500	2000 4	641564
	21		12.00-15.00			500	2000 4	641565
5.0	16	10.5	8.00-12.00	1.5	5.10-5.20	250	1000 4	641566
	18		10.00-13.00			250	1000 4	641567
	20		12.00-16.00			250	1000 4	641568
	25		16.00-20.00			250	1000 4	641569



## 3.0 Flat head blind rivet ALU/STEEL - painted

**PCS.**

Group	<b>2402</b>
Material	<b>ALUMINIUM/STEEL</b>
Norm symbol	<b>AIA/St</b>
Standard	<b>PN-EN ISO 15977</b>

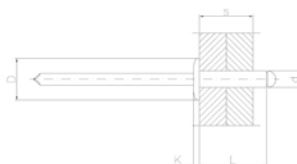

Aluminium and steel rivets are a group of the most comprehensively used products in the construction industry. Since they can be painted, they are an excellent finish to the construction. The presented offer of painted rivets is just a selection of colours. The full range of colours is available on request.









RAL									INDEX	
7016	4.0	8		3.00-5.00			500	2000	647455	
8007							500	2000	647456	
8017							500	2000	647457	
9005							500	2000	647458	
9006							500	2000	647459	
9010							500	2000	647460	
1002		10						500	2000	647461
3009								500	2000	647462
3011								500	2000	647463
6002								500	2000	647464
7016								500	2000	647465
7024								500	2000	647597
8001			500	2000	647596					
8003			500	2000	647466					
8004			500	2000	647467					
8014			500	2000	647468					
8017			500	2000	647469					
9005			500	2000	647470					
9006			500	2000	647471					
9010			500	2000	647472					





## 3.0 Flat head blind rivet ALU/STEEL - painted

PCS.

RAL	 d	 L	 D	 s	 k			 KG	INDEX
1002	4.8	10	10.1	4.00-6.00	2.0		500	2000	647473
3011							500	2000	647599
3009							500	2000	647598
6002							500	2000	647600
6020							500	2000	647474
7016							500	2000	647475
8001							500	2000	647476
8003							500	2000	647601
8004							500	2000	647602
8014							500	2000	647603
8017							500	2000	647477
9005							500	2000	647604
9006							500	2000	647605
7024							500	2000	647606
9010							500	2000	647607





## 4.1 Flat head sealed blind rivet STEEL/STEEL

**PCS.**

Group	<b>2406</b>
Material	<b>STEEL/STEEL</b>
Norm symbol	<b>St/St</b>
Standard	<b>PN-EN ISO 15979</b>

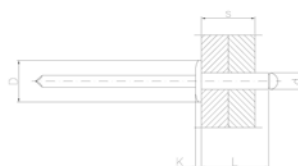

The flat head sealed rivet is characterized by a closed structure. It makes it well designed for connections in the construction industry. It can be applied wherever full tightness of the connection is required, such as on a roof. Flat-head sealed rivets effectively connect materials that are subject to vibration or large temperature fluctuations.

d	L	D	s	k			kg	INDEX
4	8	8.4	1.5-3.0	1.7	4.1-4.2	500	4000 (8)	641570
	10		3.0-5.0				2000 (4)	641571
	12		5.0-6.5				2000 (4)	641572
	15		6.5-10.5				2000 (4)	641573
4.8	9.5	10.1	3.0-5.0	2.0	4.9-5.0	500	2000 (4)	641574
	12		5.0-6.5				2000 (4)	641575





## 4.2 Flat head sealed blind rivet ALU/STEEL

PCS.

Group	<b>2407</b>
Material	<b>ALUMINIUM/STEEL</b>
Norm symbol	<b>AIA/St</b>
Standard	<b>PN-EN ISO 15974</b>



The flat head sealed rivet is characterized by a closed structure. It makes it well designed for connections in the construction industry. It can be applied wherever full tightness of the connection is required, such as on a roof. Flat-head sealed rivets effectively connect materials that are subject to vibration or large temperature fluctuations.

d	L	D	s	k				INDEX
3.2	8	6.7	2.0-3.5	1.3	3.3-3.4	1 000	4 000 (4)	641576
	9.5		3.5-5.0			1 000	4 000 (4)	641577
	12.5		6.5-8.0			1 000	4 000 (4)	641578
4	8	8.4 8.0 8.0	0.5-3.5	1.7	4.10-4.20	500	4 000 (8)	641579
	9.5		3.5-5.0			500	2 000 (4)	641580
	12.5		6.5-8.0			500	2 000 (4)	641582
4.8	8.5	10.1	0.5-3.5	2.0	4.90-5.00	500	2 000 (4)	641583
	9.5		3.5-5.0			500	2 000 (4)	641584
	11		5.0-6.5			500	2 000 (4)	641585
	12.5		6.0-8.0			500	2 000 (4)	641586
	13		6.5-8.0			500	2 000 (4)	641587
	14.5		8.0-9.5			500	2 000 (4)	648622
	16		9.5-11.0			500	3 000 (6)	648623
	21		13.0-16.0			250	1 000 (4)	641590



## 4.3 Sealed flat head blind rivets A2/A2

**PCS.**

Group	<b>I2406</b>
Material	<b>A2/A2</b>
Norm symbol	<b>A2/SSt</b>
Standard	<b>PN-EN ISO 16585</b>

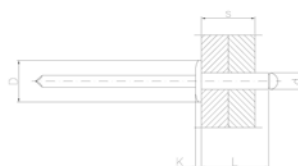

The flat head sealed rivet is characterized by a closed structure. It makes it well designed for connections in the construction industry. It can be applied wherever full tightness of the connection is required, such as on a roof. Flat-head sealed rivets effectively connect materials that are subject to vibration or large temperature fluctuations.

d	L	D	s	k				INDEX
3.2	8	6.7	1.5-3.0	1.3	3.30-3.40	500	4000 (8)	648612
	9.5		3.0-4.0					648613
	10		3.5-5.0					648611
	12		5.0-6.5					648614
4.0	8	8.4	1.5-3.0	1.7	4.10-4.20	500	2000 (4)	647827
	9.5		3.0-5.0					647828
	10		3.5-5.5					647829
	12		5.0-6.5					647821
	14		6.5-8.0					647830
	16		8.0-11.0					647831
4.8	9.5	10.1	3.0-5.0	2.0	4.90-5.00	500	2000 (4)	647822
	12		5.0-6.5					647832
	14		5.0-7.5					647823
	16		6.5-9.0					647833



## 5.0 Flat head rivet multigrip ALU/STEEL

**PCS.**

Group	<b>2409</b>
Material	<b>ALUMINIUM/STEEL</b>

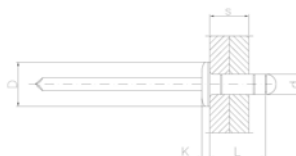

Rivets are one of the basic fasteners used in joining steel parts. Multigrip rivets have slightly better properties than ordinary rivets. First of all, they have a wider clamping range. Because of this, the number of riveted joints can be significantly reduced. This has a direct impact on the speed of installation works and cost reduction. A characteristic feature of Multigrip rivets is better joining of irregular holes. The connections are more durable and reliable and they eliminate the rattling effect.

d	L	D	s	k				INDEX
3.2	11	6.7	2.50-7.00	1.3	3.30-3.40	500	2000 (4)	648 583
4.0	9.5	8.4	2.00-6.50	1.7	4.10-4.20	500	2000 (4)	641 592
	12.5		3.50-8.50			500	2000 (4)	641 593
	16.5		6.00-12.50			500	2000 (4)	649 213
4.8	10.5	10.1	1.50-6.00	2.0	4.90-5.00	250	1000 (4)	648 586
	15		3.50-9.50			250	1000 (4)	648 884
	16.5		6.00-12.50			250	1000 (4)	648 587
	18		8.00-14.00			250	1000 (4)	641 598
	19.5		10.00-16.00			250	1000 (4)	648 588
	25		12.50-19.50			250	1000 (4)	648 589



## 6.0 Flat head blind rivet ALU/STEEL

**PCS.**

Group	<b>2410</b>
Packaging	<b>Item line</b>
Material	<b>ALUMINIUM/STEEL</b>

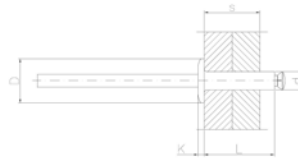

Expansion rivets are characterized by a high clamping force, shank end retention and expansion on the inner side. It makes them resistant to tensile strength. They are made of an aluminium sleeve equipped with cutting edges. During the riveting process the rivet sleeve is cut at the edges, and the resulting tabs bend into form an arc. These rivets are mainly used for attaching components to soft materials such as wood, plastic, drywall, etc.

d	L	D	s	k				INDEX
4.0	12	8.4	4.00-6.50	1.7	4.2-4.30	500	2 000 (4)	641600
	16		8.00-11.00			500	2 000 (4)	641601
4.8	16	10.10	6.00-9.50	2.0	5.20-5.30	500	1 500 (4)	648624
	18		8.00-12.00			500	1 500 (4)	648627
	21		10.00-14.00			250	1 000 (4)	641605
	24		12.00-19.00			250	1 000 (4)	641606







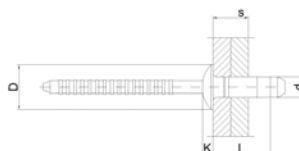

# 7.0 Flat head blind rivet HARD LOCK STEEL/STEEL

**PCS.**

Group	<b>2412</b>
Packaging	<b>Item line</b>
Material	<b>STEEL/STEEL</b>
Norm symbol	<b>St/St</b>



A Hard Lock reinforced rivet is characterized by high shear and tensile strength. Due to its design it ensures a very stable connection in areas subject to vibrations, as well as in irregular holes, providing a replacement for other rivets. The pressure load on the shank is on the extended side providing a large load bearing area, making it ideal for use in sheet materials. It is used in the automotive, railroad and metal furniture industries.

 d	 L	 D	 s	 k			 KG	INDEX
6.4	12.5	13.4	4.80-6.80	3.5	6.70-6.90	250	1 000 (4)	649512
	14.5		6.80-8.80			250	1 000 (4)	649513
	16.5		8.80-10.80			250	1 500 (6)	649514



## 8.0 Riveting tool blind rivets - right angle type

Group	9901
-------	------



The hand riveting machine is universally applicable, in particular due to its ergonomics, ease of use and simplicity. It is ideal for fixing rivets in hard-to-reach places.

RIVETING RANGE	INDEX
3,0 - 5,0	16831

# **GUARANTEE**

*100% assortment  
availability*

IDEA consignment stores - Eliminate costs in your warehouse with kanban-enabled warehouses.

**Our many years' experience of working with companies in the B2B market resulted in the IDEA project.**

**We have combined a consignment storage system which ensures continuity of inventory maintenance at the customer's site, with a Kanban-type inventory control method.**

***The IDEA system is:***

- ✓ Guarantee of 100% assortment availability in the customer's warehouse - warehouse costs reduction and time savings.
- ✓ Payment for goods only at the time of collection from the warehouse
- ✓ Cyclical analysis and adaptation of inventories to current customer needs.

Contact us! [skladyidea@marcopol.pl](mailto:skladyidea@marcopol.pl)





a brand that connects

Head Office / Export Department  
Главный офис / Отдел экспорта  
Hauptsitz / Exportabteilung  
Centrinė buveinė / Eksporto skyrius

**POLAND**  
Marcopol Sp. z o.o.  
Chwaszczyno  
Oliwska 100 Street  
80-209 Chwaszczyno

Tel: **+48 58 55 40 410**  
Fax: **+48 58 55 40 419**  
**export@marcopol.eu**  
**www.marcopol.eu**

Foreign Branches  
Иностранные офисы  
Ausländische Niederlassungen  
Užsienio skyriai

**LITHUANIA**  
UAB Marcopol  
Baltija  
UAB „Marcopol Baltija“  
Pirklių g.5  
LT-02300 Vilnius, Lietuva  
Tel.: +370 52 306 183  
Fax: +370 52 137 184  
baltija@marcopol.lt

Kaunas  
Draugystės 13A  
LT-51224 Kaunas, Lietuva  
Tel.: +370 37 280 832  
Fax: +370 52 137 184  
kaunas@marcopolbaltija.lt

**RUSSIA**  
ООО Маркопол  
КЛД Трейдинг  
Россия  
г. Калининград  
Ул. Гагарина 239  
Тел.: +7 (4012) 51 50 35  
Моб. тел. +7 962 260 1940  
kaliningrad@marcopol.ru

Klaipėda  
Šilutės plentas 79  
LT-94101 Klaipėda, Lietuva  
Tel.: +370 46 470 413  
Fax: +370 52 137 184  
klaipeda@marcopolbaltija.lt

Šiauliai  
Metalistų g. 6h  
LT-78107 Šiauliai, Lietuva  
Tel.: +370 41 201 212  
Fax: +370 52 137 184  
siauliai@marcopolbaltija.lt

**ESTONIA**  
Marcopol  
Estonia OÜ  
Sepa 15G  
50113 Tartu, Eesti  
Tel.: +372 7401 410  
Fax: +372 7401 411  
Mob.: +372 5097 923  
estonia@marcopol.ee

[www.marcopol.eu](http://www.marcopol.eu)

# INTERNATIONAL SALES NETWORK

